

BREL motors is part of:

BREL nederland b.v.

Manual Brel for standard curtaintrack motor

Type MGS-45

Read the manual before you begin the installation. If these instructions are not followed, this may lead to defects and injury in which warranty can't be claimed.

warning:

Children cannot recognize the dangers of electrical equipment and may therefore not work with it.

It is important to follow this instruction for your own safety.

1. Do not operate the motor in humid surroundings.
2. The motor must be installed correctly.
3. Keep the antenna in a good condition and do not shorten. The antenna should not come into contact with other metal parts otherwise it will reduce the effect.
4. The motor must be protected from direct moisture influences.



Functions wall switch

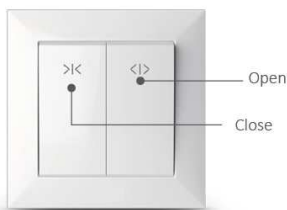

DC-865

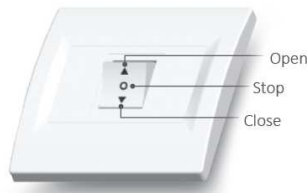

DC-22

Technical data of the motor

- Motor Voltage: 230V
- Power: 45 Watt
- Speed: 12 rpm
- Max. curtain weight: 40 kg
- Ampèrage 0.23 A
- Max. duration: 4 min.
- Moisture and dust: IP40
- Working temperature of the motor:
 - o Normal use: -10°C tot +40°C
 - o Heavy use: -20°C tot +70°C

Type MGS45



Functions

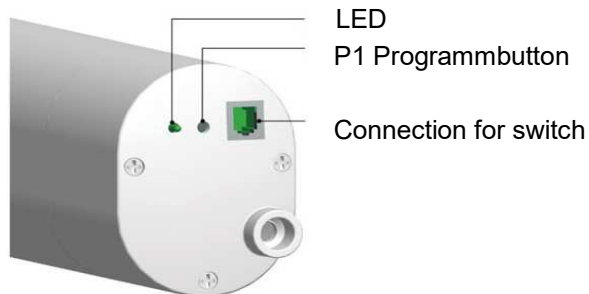

Wiring chart

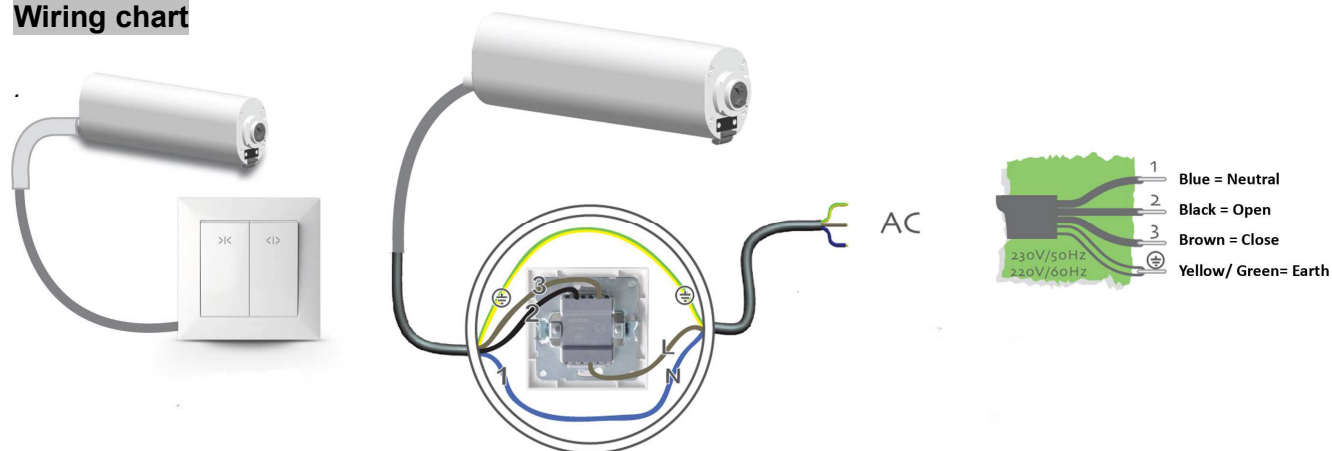

Installation motor and rail

Attach the rail to the wall / ceiling.

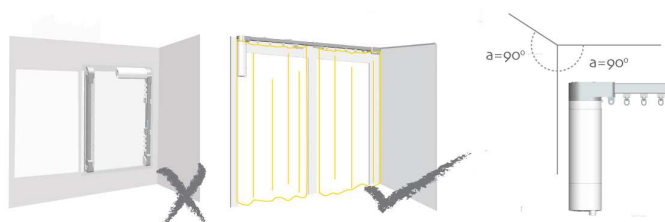

Mount the rail not vertical.

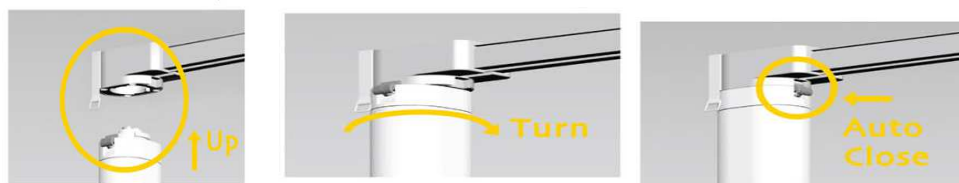

If the motor don't want to click easily, turn the gear wheel a bit and try again.

Setting the end positions Operate the motor for the first time and it automatically searches the end positions.

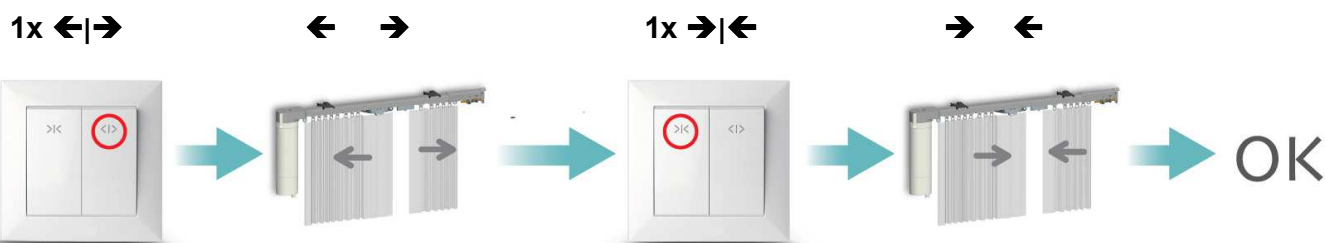

Press the open button.
DO NOT press **STOP!**

The curtain opens completely and stops hard at the end.

Press the close button.

The curtain closes completely and stops hard in the middle.

If the end positions are set with a hard stop, the curtain will stop 1 cm before the end in the future.

Cancel end positions Go to previous action to automatically reset the end positions.

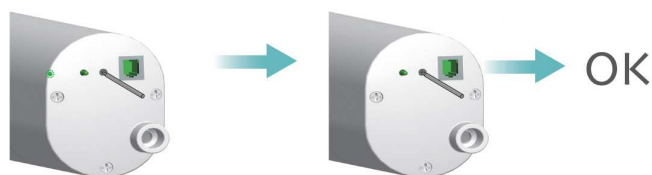

Hold down P1. LED will light up for a long time. Release when the LED flashes and goes out.