

BREL motors is part of:

**BREL** nederland b.v.

## Manual Brel tilt only DC electronic radio motor

### Type MTE50-0.6

**Read the manual before you begin the installation. If these instructions are not followed, this may lead to defects and injury in which warranty can't be claimed.**

#### warning:

Children cannot recognize the dangers of electrical equipment and may therefore not work with it.

**It is important to follow this instruction for your own safety.**

1. Do not operate the motor in humid surroundings.
2. The motor must be installed correctly.
3. Keep the antenna in a good condition and do not shorten. The antenna should not come into contact with other metal parts otherwise it will reduce the effect.
4. The motor must be protected from direct moisture influences.

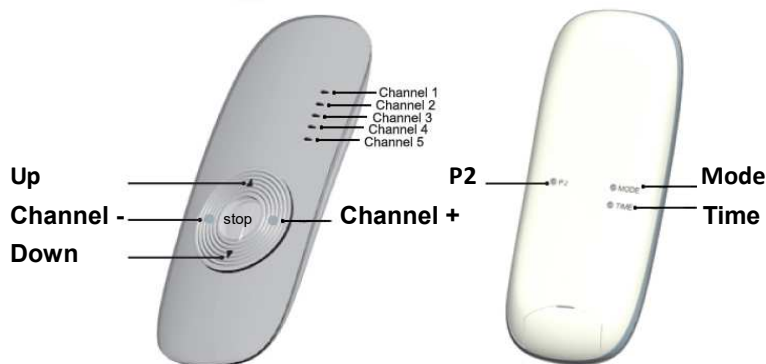

*If in the 5 channel transmitter all the lights are lid. All the products are operated simultaneously. (mode and time have only a function on an emitter with a timer)*

#### Technical data of the motor

- Motor Voltage:
- Charge Voltage:
- Maximum ampère charger:
- Power:
- Torque:
- Speed:
- Ampèrage
- Moisture and dust:
- Storage capacity is up to 20 channels
- Working temperature of the motor:
  - Normal use: -10°C tot +40°C
  - Heavy use: -20°C tot +70°C

#### Type MTE50-0.6

DC 12V  
DC 12V  
1.0 A  
7 Watt  
0.6 Nm  
10 rpm  
0.58 A  
IP20

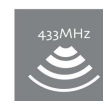



## Power supply by 12V rechargeable Li- Ion battery DC -1200 with Charger DC -212 or transformer 12V DC -210.

The battery is fully charged when the light on the charger changes from red to blue.

Make sure that during installation the motor is sufficiently charged.

Note that the motor is not operated during charging.



### Functions

### Reach

L1 = 100 meter

L2 = 25 meter

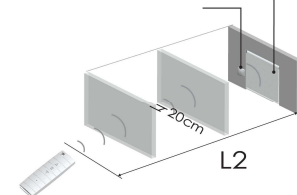
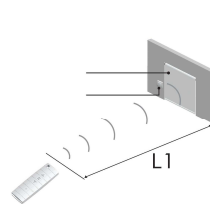
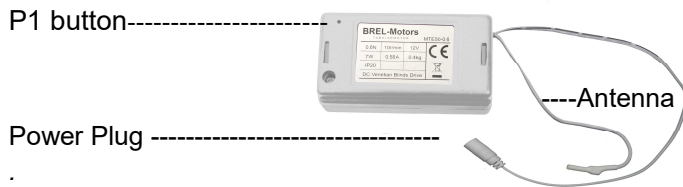

### Installing the motor

During programming the motor the following must be done within 10sec.

After 10 sec. the motor will quit the programming mode.



T < 10S



**Tip:** When the engine has finished moving up and down, you can move on with the following action.

**EMERGENCY CONTROL:** If a transmitter has been paired and the end positions determined in the motor, you can use the P1 key as the control key.

### Step 1 Setting up the first channel

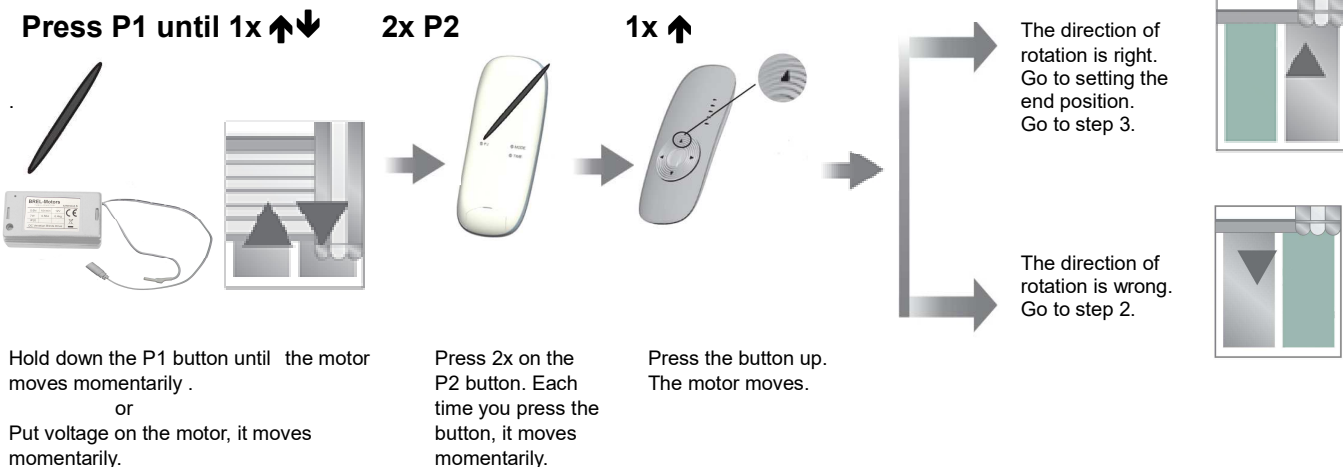

**With the above action you will delete all channels in memory and the final setting.**

## Step 2 Change direction

**Variant A** If the direction is right, skip step 2 and proceed to step 3.

**Press P1 until 1x ↑↓**

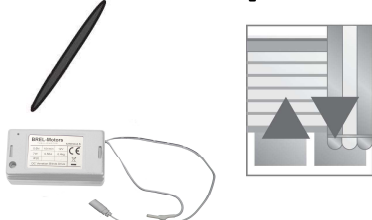

Hold down the P1 button until the motor moves 2x momentarily (and beeps).

**2x P2**



Press 2x on the P2 button. Each time you press the button, it moves momentarily.

**1x ↓**



Press the button down. The motor moves.

**1x ↑**



Press the button up.

**↑**

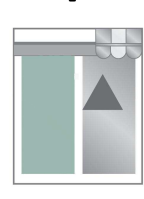

The product will now go up. Reading the first transmitter has been completed. You can now proceed with setting the end limits.

## Variant B

**Press P1 until 2x ↑↓**



Hold down the P1 button until the motor moves 2x momentarily (and beeps).

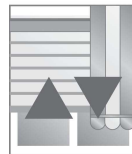

The product moves momentarily 2x. The direction of rotation is changed.

## Step 3 Setting the end limits

If no limit positions are set, the motor will only move in the pulse setting.

**1x P2**



Press the P2 button. The motor moves momentarily.

**1x ↑**



Press the button up. The motor moves momentarily.

**1x P2**

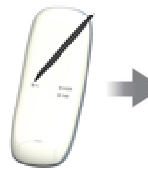

Press the P2 button.

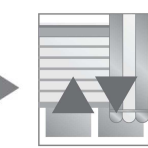

It moves momentarily.

**1x ↑**



Set the product on the desired top position.

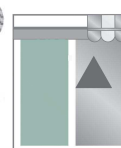

**STOP until ↑↓**



Hold the stop button until the motor moves momentarily.



**1x ↓**

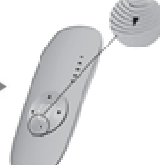

Set the product on the bottom position.



**STOP until ↑↓**



Hold the stop button until the motor moves momentarily. Limit setting is ok.



## Step 4 Setting third limit position

If you press the stop button for more than 3 seconds, the motor will move from any position to the third limit position.

**1x P2**



Go to the desired third limit position

**2x STOP**



Press stop button 2x.

**↑↓**



It moves momentarily for confirmation.

**To remove the third limit position, you must go to the third position and repeat above action.**

## Additional settings

### Option A Delete limit position

Deleting the limit position can be done in two ways:

1. When step 1, setting up the first channel also the limit setup will be removed.
- 2.

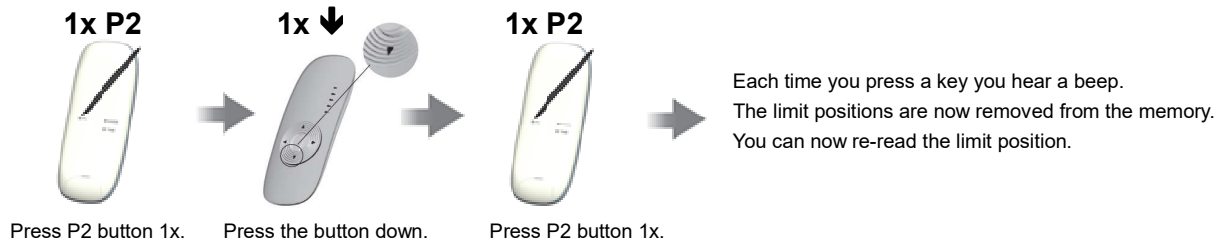

### Option B Teaching multiple transmitters (Up to 20 transmitters per receiver)

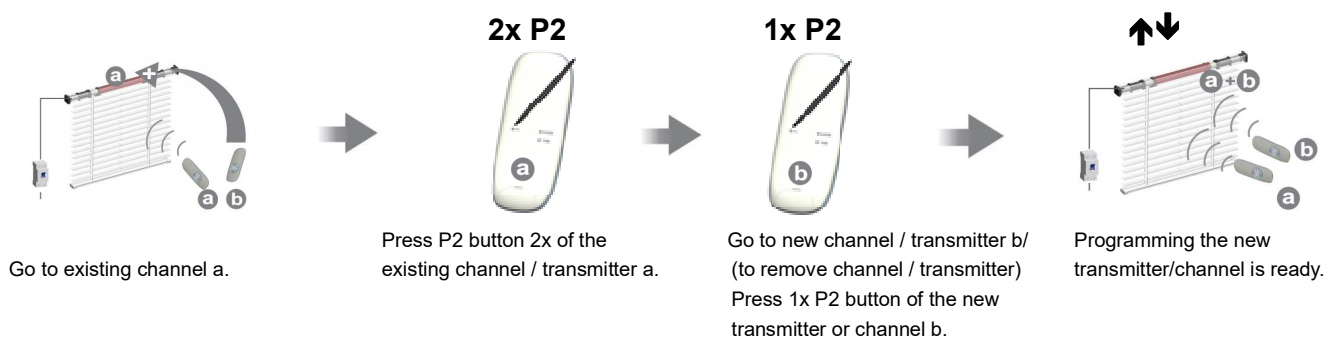

*To delete one channel , you must repeat the above operation.*

### Option C Delete all

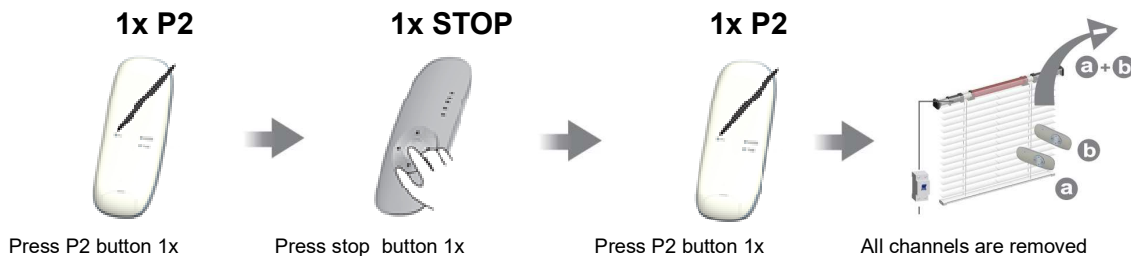

### Option D Pulse setting

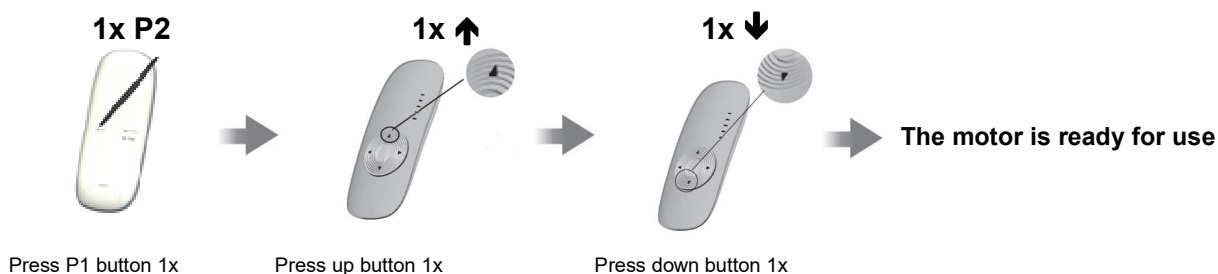

*To remove the pulse setting, repeat the above operation.*

---

**Option E**    Pairing new remote while maintaining end limits. Only possible if the end limit is set.

---

**Press P1 until 1x ↑↓**



**↑↓ simultaneously**



Press P1 and hold, until the motor moves up and down.

Press up and down buttons simultaneously,  
until the motor moves up and down.

---

**Option F**    Reset everything

---

**Press P1 until 3x ↑↓**



Press P1 and hold, until the motor moves up and down 3x.