



INSTALLATION MANUAL

Manual Brel Bi-directional Wifi Curtain Rail Motor

BG-980

Read the manual before you begin the installation. If these instructions are not followed, this may lead to defects and injury in which warranty can't be claimed.



www.brel-home.com

Visit our website for more manuals and information



BG-980

Scan the QR code here for the manual to
download & view instructional videos

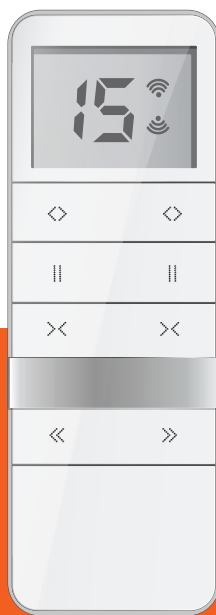

Table of Content

Warning	2
Switching installation of the curtain motor	3
Works with all BREL transmitters	3
Technical data of the motor	3
Functions remote control/Function/ Installation of the Motor	4
Settings	5

Warning

It is important to follow this instruction for your own safety.



Do not operate the motor in humid surroundings.



BREL-Motors declares that this motor has been manufactured according to the guidelines of the CE standard 1999/5/EC



The motor must be protected from direct moisture influences.



Keep the antenna in a good condition and do not shorten. The antenna should not come into contact with other metal parts otherwise it will reduce the effect.



The motor must be installed correctly.



This product must not be disposed of with household waste. Take the remote control and battery to the designated collection points"



Children cannot recognize the dangers of electrical equipment and may therefore not work with it.

Switching installation of the curtain motor

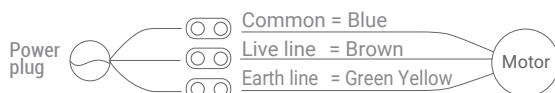
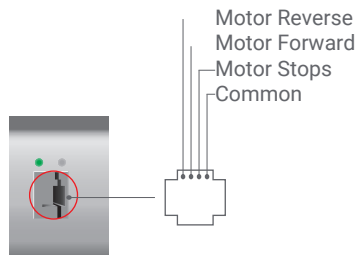
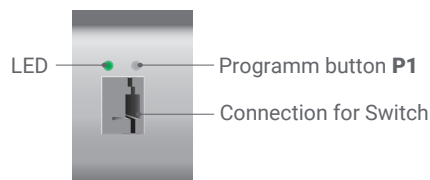

Works with the BREL HOME app

The BG980 motor is easy to operate with the BREL HOME app. The motor connects to the BREL HOME app via WiFi and then the motor can be set via the app. The steps are as followed:

Step 1: Go to settings -> Wifi network -> choose the connection to your home network -> disable the "automatic connection" to your home network.

Step 2: Download the BREL HOME App and create an account (SIGN UP)

Step 3: Click on add product and choose the Wifi motor

Step 4: Go through all the steps as indicated in the app.

Step 5: Close the app completely -> restart the app -> click on ADD ROOM and create the room where the product is located.

Step 6: Go to the WiFi motor and link the newly created room to the WiFi motor.

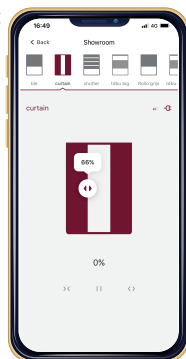

If you want to install the motor by emitter, follow the instructions on the next pages.

Technical data of the motor

BG-980

1.2 nm

Torque

Open/Close Speed

14 cm per sec.

Voltage Motor

AC 100-240V

Max. Curtain Weight

40 kg

Radiofrequency

433.925MHz

Moisture and Dust Protection

IP20

Storage Capacity Transmitters

Up to 20 Channels

Temperature range of the motor

Normal Use : -5°C to +55°C

Frequency



433Mhz 2.4Ghz (wifi)

Functions Remote control

DD-1852

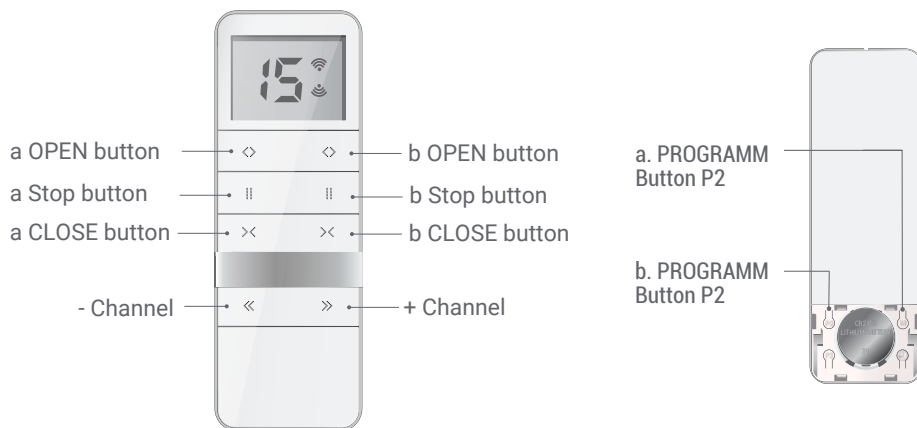

Scan the QR code to view the manual and instructional videos

BG980

Reach

L1 = 100 meter

L2 = 20 meter

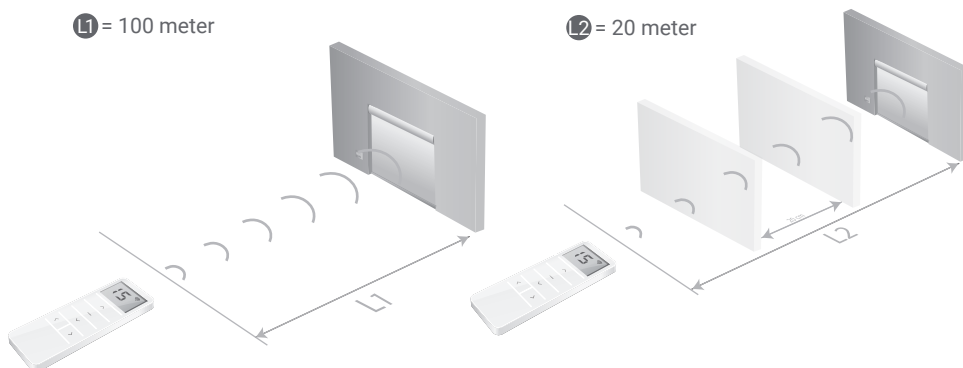



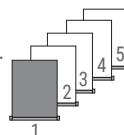

Step 1 Setting up the first remote/channel

- i** The remote control can transmit 15 channels and therefore control multiple blinds. First, select a channel for operating the relevant roller blind. Make sure that you select a free channel (we recommend only 1 product per channel).
- i** This remote has also channel 0. All blinds programmed in channel 1~15 are automatically programmed in this channel 0 and can be operated all at once.
- i** In case you have selected the wrong channel, go to **Resetting factory settings**.



► **Select the desired channel.**

Step 2 Establishing connection

-  In the procedures described here is a maximum interval of 10 seconds to complete each subsequent action: if you wait any longer, the system will leave the edit mode.
-  Normally a button only needs to be pressed shortly. If you need to press and hold a button for several seconds this will be state clearly.
-  The system will confirm each completed step with moving the blind up and down (↑).
-  If a procedure does not play out as described, wait for 20 seconds and start again from the beginning of that step/procedure.

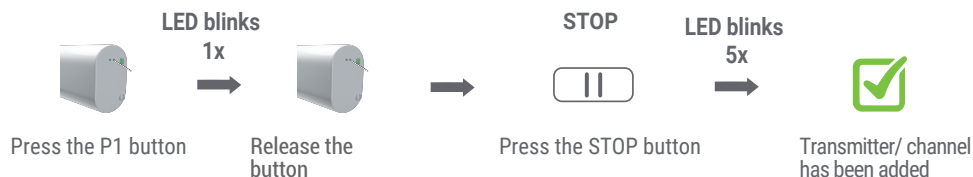

-  If NO end positions are set, the product will move in the pulse / step operation. Go then to STEP 3.
 If end positions are set, the product will continue to its end position. Go then to STEP 5.
WARNING: It is possible that the correct end positions have not been set. Go then to OPTION A.

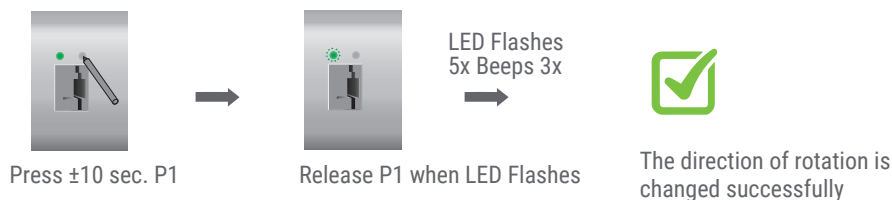

Step 3 Adjusting the direction of rotation *(Only if the direction of rotation is not correct)*

Only possible if no end positions are set.

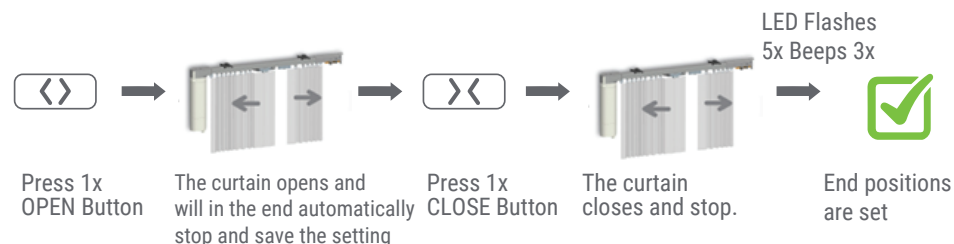

Step 4 Setting the End Limits



-  **The curtains are now ready for use.**
-  If you are not satisfied with the result of setting the end positions, go to Option A - adjusting positions or **Resetting factory settings.**

Step 5 Setting the favorite position (If desired)

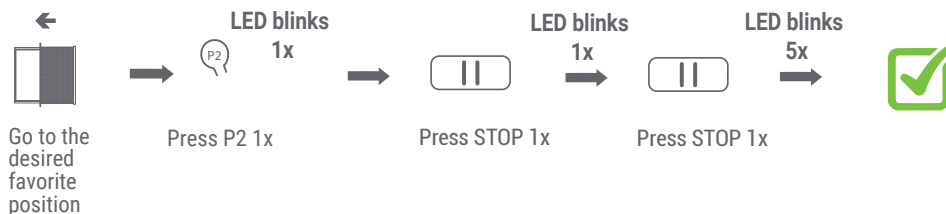

i Press and hold STOP for 3 seconds to move to the favorite position.

i Since the procedure is identical, to remove it repeat the steps.

Additional settings

Option A Adjusting the open position

i If adjustment is not possible, go to **Resetting factory settings**.

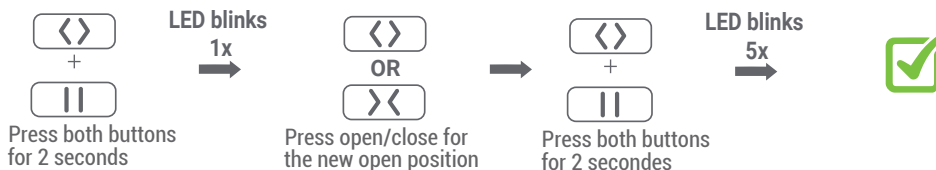

Adjusting the close position

i If adjustment is not possible, go to **Resetting factory settings**.

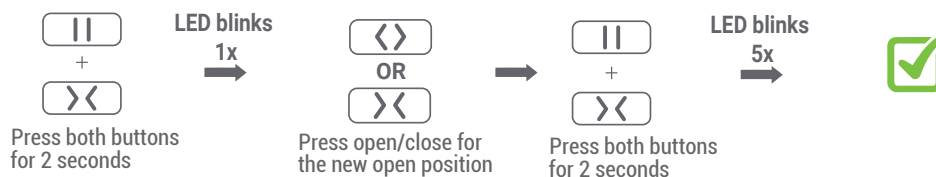

Option B Learn Extra transmitter/channel

i Make sure the new transmitter is in the desired channel.

a = Already existing transmitter/channel

b = New transmitter/channel

NOTE To delete the transmitter / channel repeat the procedure.

Method 1

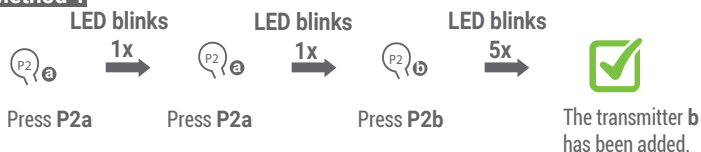

Method 2 (In case the old transmitter is lost or broken)

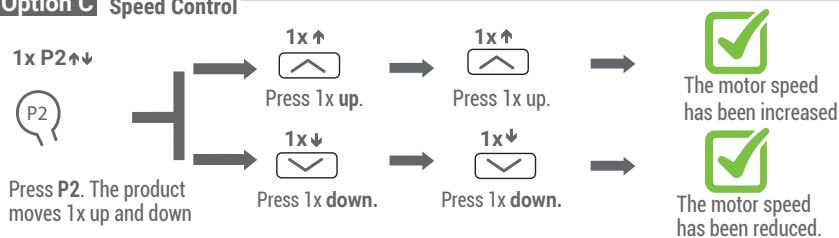

Option C Speed Control

i If the motor does NOT react after this action, it is already at the highest or lowest speed.

i There are 3 different speeds.

i If the speed has been changed the slow stop is activated. To deactivate the slow stop you have to reset the motor.

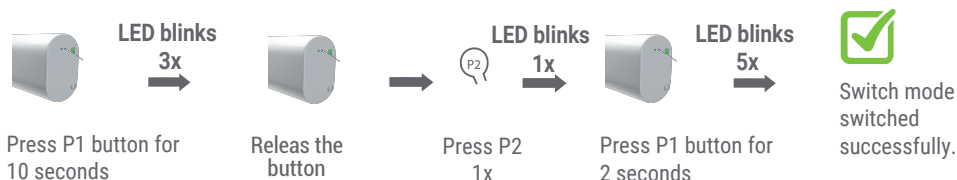
External Switch Mode Pushbutton switch mode (Factory default)**Mechanical switch mode**

Check both upper and lower limits are set, the motor is power-on (1 jog), within 10S.

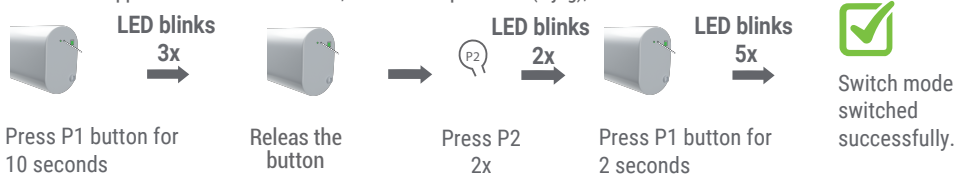
**Electronic switch mode**

Check both upper and lower limits are set, the motor is power-on (1 jog), within 10S.

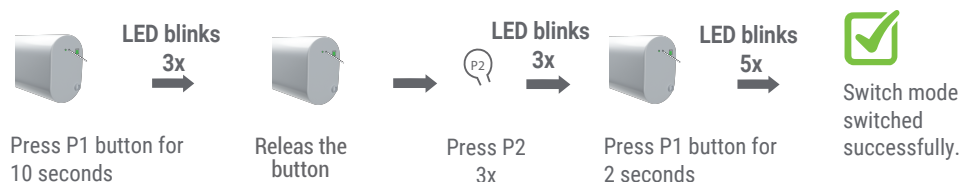
**Single button pushbutton switch mode**

Check both upper and lower limits are set, the motor is power-on (1 jog), within 10S.

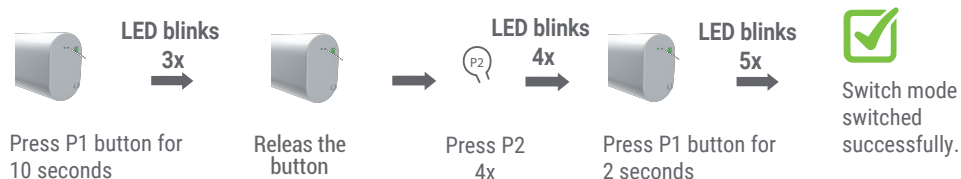

Additional settings P1 button

Can be used without a transmitter as an operating button.



The LED light blinks when pressed P1

Manual control

LED blinks

3x



STOP



LED blinks

5x

Press the P1 button
for 10sRelease the
button

Press the STOP button

Manual control has been
(de) activated.**Switching off the receiver**

until



Press and hold P1 until the LED light blinks 2x.

The Receiver
switched off.

To reactivate the receiver, briefly press P1 once.

Changing the direction of rotation**Method 1 (with end limits)**

LED blinks

3x



LED blinks

5x



Press and hold P1 for 10s

Loosen button

Press 1 second

The direction of
rotation has changed.**Method 2 (without end limits)**

LED blinks

5x



+

Press both
buttons for 2 secThe direction of
rotation has changed.**Resetting to factory settings**

LED blinks 8x

Press the P1 button
for 14 seconds

Releases the P1 button

Resets to factory settings.

 To apply new settings: go to step 1**Changing Batteries**